

Barrette Structural Inc.
Design No. BS/SFWT 60-10
Load Bearing Fire Resistance Rated Roof/Ceiling, Floor/Ceiling Assembly
Open Joist 2000® Joist Series
ASTM E119 and CAN/ULC S101
Rating: 1 Hour

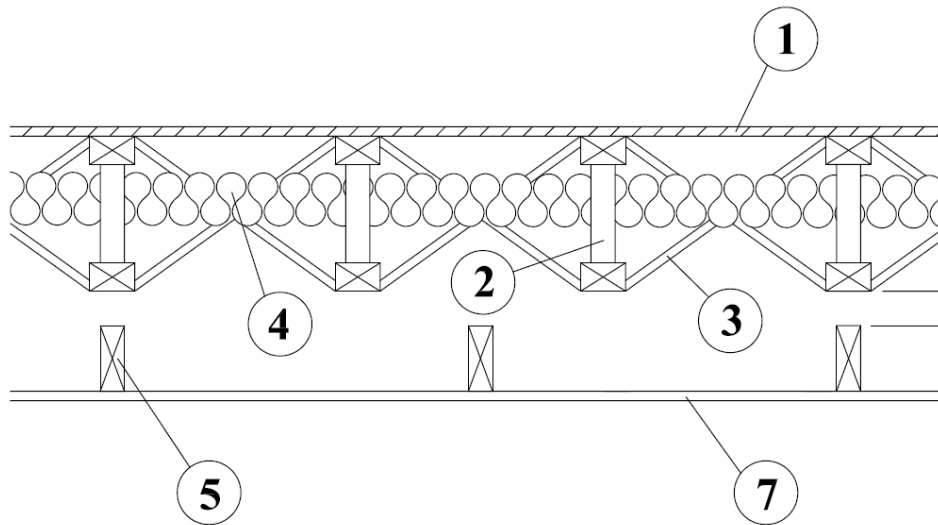

1. SUB-FLOORING AND FLOOR TOPPING: Min. 23/32 in. thick tongue-and-groove wood structural sub-flooring panel.

2. CERTIFIED MANUFACTURER: Barrette Structural Inc.

CERTIFIED PRODUCT: Open Joist Series

CERTIFIED MODEL: Open Joist 2000®

Open Joist 2000®, 9-3/8 in. min. depth, installed up to 24 in. on center (oc), with structural graded nominal 2x3 or 2x4 chords per NLGA grading rules. Structural member should bear the Intertek Certification Mark. The joists must be fireblocked in accordance with local Codes.

3. CROSS BRIDGING: Min. 1x3 or 2x10 solid blocking.

4. INSULATION (Optional): Certified glass fiber or mineral fiber batt, at 3-5/8 in. thickness and minimal nominal density of 0.6 pcf, friction-fitted between joists on underside of sub-flooring (Item 1).

When installed, insulation must be supported by stay wires spaced at 12 in. oc.

5. RAFTERS: Nominal 2x6, 8 in. depth, installed at max. 24 in. oc, bridged laterally with solid blocking max. 7 ft. oc.

As an alternate to the rafters, light GA steel truss system manufactured from cold-formed, galvanized steel chords (min. 18 GA) and web members (min. 20 GA) conforming to ASTM A653 Grade 33 or higher yield strength. Truss chord and web members to be designed in accordance with American Iron and Steel Institute's Specification for Design of Cold-Formed Steel Structural Members.



6. **SHEATHING (Optional, Not Shown):** Rafters (Item 5) may be sheathed with plywood, gypsum (Item 7), or mineral and fiber boards. When plywood sheathing is used, solid blocking for rafters may be omitted.
7. **GYPSON BOARD:** One layer of 5/8 in. thick gypsum board installed with long dimension perpendicular to rafters (Item 5) with end joints located under bottom of rafters. The boards are installed using 1-7/8 in. long 6d cement coated cooler nail or 1-7/8 in. long No. 6 Type S bugle-head steel screws, spaced 7 in. oc along the edges and in the field.